

DIRECTIONS FOR RUNNING THE BINAXNOW COVID-19 AG CARD SELF TEST

Carefully read instructions prior to starting test.
It is recommended gloves (not provided) also be used during testing.

BEFORE STARTING

1. Wash or sanitize your hands. Make sure they are dry before starting.



A. PREPARE FOR THE TEST

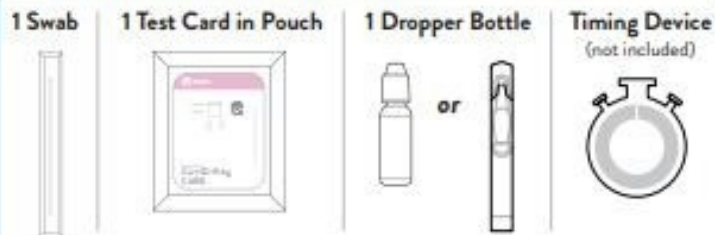

- ! DO NOT touch any parts on the inside. Handle card only by edges.
- ! Card must stay FLAT on table for entire test.

2. Remove test card from pouch and lay flat on table.

The card must stay flat on the table for the entire test.

Make sure the blue control line is present in the result window. If a blue line is not present, do not use this card.

Open card flat on table. You may bend the spine in the opposite direction to help the card lay flat.

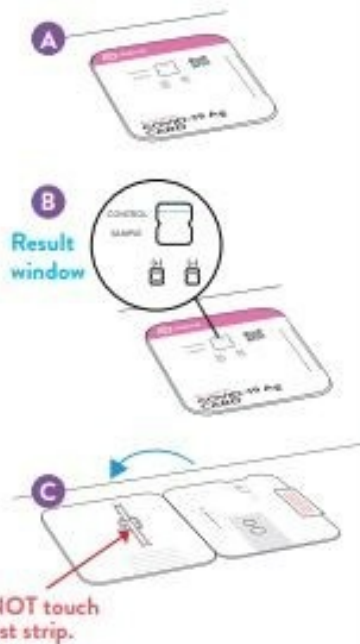

3. Remove dropper bottle cap. Hold dropper bottle straight over top hole, not at an angle. Put 6 drops into top hole. Do not touch card with tip.



Note: False negative result may occur if less than 6 drops of fluid are put in the hole.

B. COLLECT NASAL SAMPLE

- ! Keep fingers away from the swab end.

4. Open swab package at stick end. Take swab out.

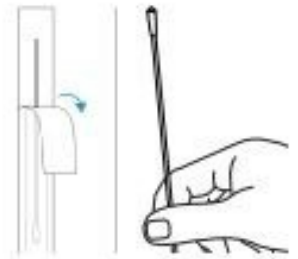

5. Swab both nostrils carefully as shown.

Insert the entire soft tip of the swab into a nostril (usually 1/2 to 3/4 of an inch).

You do not need to go deeper.

A
Up to 3/4
of an inch



Using medium pressure, rub the swab against all of the inside walls of your nostril.

Make at least 5 big circles. Do not just spin the swab.

Each nostril must be swabbed for about 15 seconds.

B
At least 5
big circles



Using the same swab, repeat step 5 in your other nostril.

C
At least 5
big circles



Check:
Did you swab BOTH nostrils?

Note: False negative result may occur if the nasal swab is not properly collected.

C. PERFORM THE TEST

! **Keep card FLAT on table.**

6. Insert swab tip into **bottom hole**.



Firmly push the swab tip from the bottom hole until it is visible in the **top hole**.



Do not remove the swab from the card.

7. Turn swab to right 3 times to mix the swab with the drops.

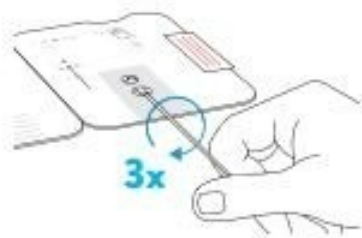

Do not skip this step.

Leave the swab in the card for the remainder of the test.

Note: False negative result can occur if swab is not turned.

! **DO NOT** remove swab.

8. Peel adhesive liner off. Be careful not to touch other parts of card.



Close left side of card over swab. Press firmly on the two lines on right edge of card to seal.



Keep card face up on table.

! **DO NOT** move or touch the card during this time.

9. **Wait** 15 minutes.

Read the result at 15 minutes.

Do not read the result before 15 minutes or after 30 minutes.



Note: A control line may appear in the result window in a few minutes but a sample line may take as long as 15 minutes to appear.

Note: Results should not be read after 30 minutes.

D. INTERPRET RESULTS

A. Check for Positive COVID-19 Result

Find result window and look carefully for two pink/purple lines.

Positive Result: If you see two pink/purple lines (one on the top half and one on the bottom half), this means **COVID-19 was detected**.

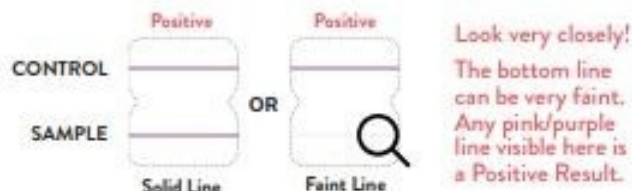

Below are photos of actual positive tests. On the right, note how faint the bottom line can get.



B. Check for Negative COVID-19 Result

Find result window and look for a single pink/purple line in window.

Negative Result: If you see **only** one pink/purple line on the top half, where it says "Control" this means **COVID-19 was not detected**.

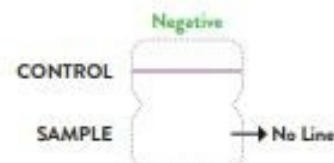

C. Check for Invalid Result

If you see any of these, the test is invalid. An invalid result means this test was unable to determine whether you have COVID-19 or not. A new test is needed to get a valid result.

Please contact Technical Support at +1 833-637-1594

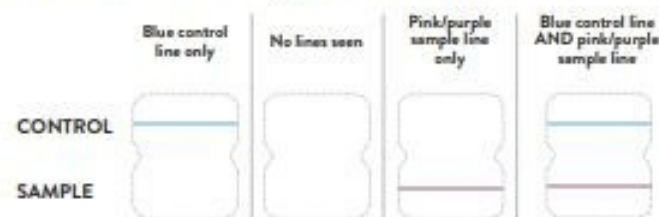

Note: See other side to read about what your results mean.

E. DISPOSE THE TEST KIT

Throw away all used test kit components in the trash.



F. REPORT YOUR RESULTS

Please share your test result with your health care provider.